

## HOW TO BREW

### 1 CHOOSE A METHOD



Use the Ninja  
Grounds Adapter

Use the Ninja  
Pod Adapter



### 2 CHOOSE A SIZE

Use the Multi-Serve arrow buttons to select the brew size. Place the empty vessel or carafe under the brew basket.

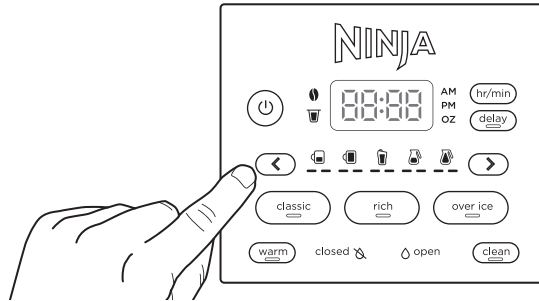

### 3 SELECT A BREW

Press either the CLASSIC, RICH, or OVER ICE brew style to start your brew. There will be an illuminating progress bar on the display to track the progress of your brew.

**THE BREW MAY PAUSE ONCE OR MULTIPLE TIMES DURING THE BREW CYCLE. THIS IS NORMAL.**

Pausing allows the coffee grounds to fully extract and unlock the full flavor of the brew style.

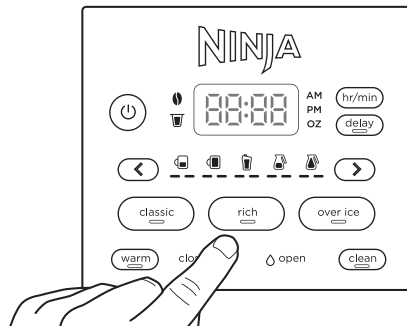

# NINJA

**DUALBREW**  
**GROUND**S & **POD**S  
HOT & ICED COFFEE MAKER

## BEFORE YOUR FIRST BREW

**IMPORTANT:** Ensure you prime your coffee maker before your first brew.

### TO PRIME YOUR COFFEE MAKER:

- 1 Plug it into an outlet and turn it on.
- 2 Fill the water reservoir to the FULL line with fresh water and place it on the base.
- 3 Place the empty carafe under the brew basket and run a water-only Full Carafe, Classic brew.
- 4 Once the brew is complete, discard the water; the coffee maker is now primed for use.

**NOTE:** If using the brewer in a high-altitude area, running a calibration brew is required. Not running a high-altitude calibration brew in a high-altitude area will result in excessive steaming during brewing. Refer to page 4 of the Owner's Guide for instructions on running a high-altitude calibration brew.

© 2023 SharkNinja Operating LLC

NINJA is a registered trademark of SharkNinja Operating LLC.

NINJA SMART SCOOP is a trademark of SharkNinja Operating LLC.

All other marks, including KEURIG and K-CUP, are trademarks of their respective owners.

## WHAT'S IN THE BOX

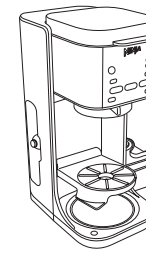

**NINJA DUALBREW  
HOT & ICED COFFEE  
MAKER**

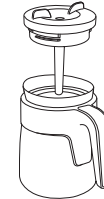

**12 CUP  
GLASS CARAFE**

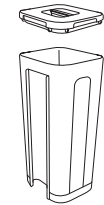

**60 OZ. REMOVABLE  
WATER RESERVOIR**



**BREW BASKET**

Comes fully installed in the brewer. It must always be inserted when brewing pods or grounds.



**NINJA  
POD ADAPTER**

Used only for brewing pods. Always insert it over the brew basket when brewing pods.



**NINJA GROUND**S ADAPTER

Comes fully installed in the brewer. Used only for brewing ground coffee. Always insert it over the brew basket when brewing grounds.



**PAPER FILTER KIT**



**ADAPTER STORAGE**

Can be installed on the back of the unit to store either the Ninja Pod or Ninja Grounds Adapter.



**NINJA SMART SCOOP™**

Use this to measure coffee grounds.

## PREPARING YOUR BREW



### NINJA POD ADAPTER For brewing pods.

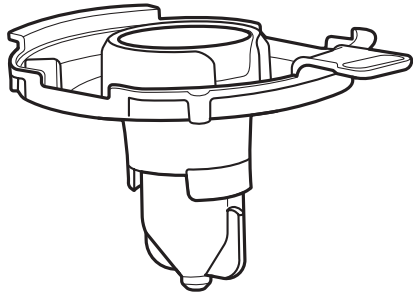

- 1 Remove the Ninja Grounds Adapter from the lid and ensure there is no filter in the brew basket

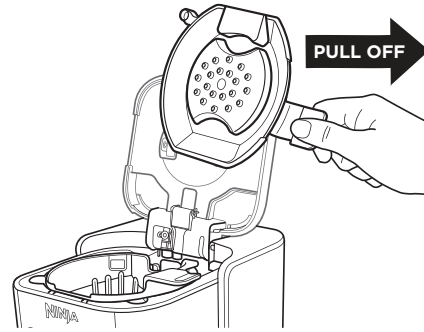

- 2 Place the Ninja Pod Adapter over the brew basket and ensure it is aligned with the brew basket handle.

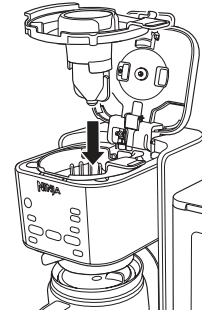

- 3 Place a pod in the Ninja Pod Adapter and close the coffee maker lid firmly to pierce the pod

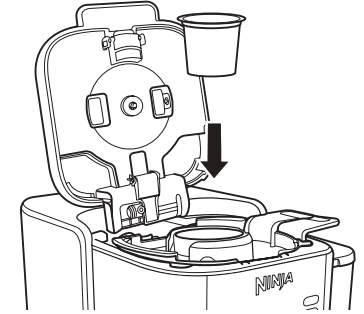

### NINJA GROUNDS ADAPTER For brewing grounds.

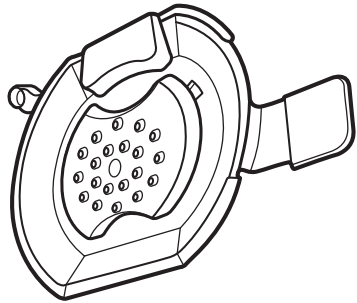

- 1 Place a #4 cone paper filter or permanent filter (sold separately) in the brew basket

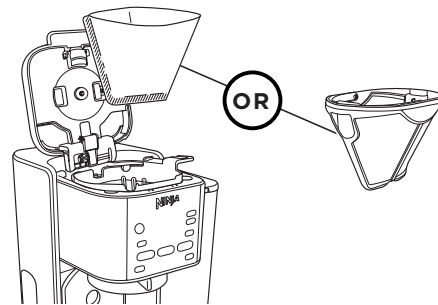

- 2 Use the Ninja Smart Scoop to fill the filter

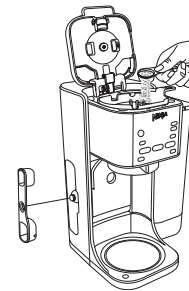

SERVING SIZE	NINJA SMART SCOOP
	GROUND COFFEE
	2-3 small scoops
	3-5 small scoops
	3-5 big scoops
	4-7 big scoops

- 3 Place the Ninja Grounds Adapter over the brew basket and ensure it is aligned with the brew basket handle. Close the coffee maker lid.

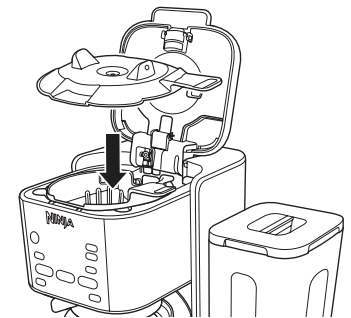

## INSTALLING THE ADAPTER STORAGE

### ADAPTER STORAGE

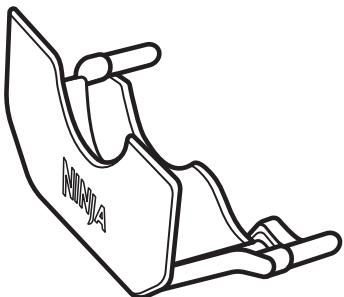

- 1 Securely fit the Adapter Storage pins into the holes on the back of the coffee maker

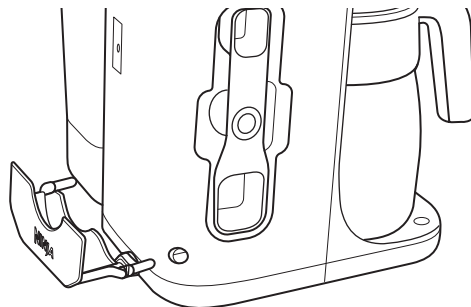

- 2 Store either the Ninja Pod or Ninja Grounds Adapter in the Adapter Storage

