

# NINJA®

**ST100**  
Series

**OWNER'S GUIDE**

## FOODI™ FLIP TOASTER



ninjakitchen.com

# THANK YOU

for purchasing the Ninja® Foodi™ Flip Toaster



## REGISTER YOUR PURCHASE

 [registeryourninja.com](http://registeryourninja.com)

 Scan QR code using mobile device

## RECORD THIS INFORMATION

Model Number: \_\_\_\_\_

Serial Number: \_\_\_\_\_

Date of Purchase: \_\_\_\_\_  
(Keep receipt)

Store of Purchase: \_\_\_\_\_

## TECHNICAL SPECIFICATIONS

Voltage: 120V- 60Hz

Watts: 1500W

**TIP:** You can find the model and serial numbers on the QR code label located on the base of the unit.

# CONTENTS

<b>Important Safeguards</b> .....	<b>2</b>
<b>Parts</b> .....	<b>4</b>
<b>Before First Use</b> .....	<b>5</b>
<b>Power Cord Management</b> .....	<b>5</b>
<b>Using the Control Panel</b> .....	<b>6</b>
Control Panel Display & Operating Buttons .....	6
Functions .....	7
<b>Using Your Foodi™ Flip Toaster</b> .....	<b>8</b>
Using the Cooking Functions .....	8
Bake .....	8
Broil .....	8
Reheat .....	8
Toast .....	9
Bagel .....	9
Defrost .....	9
<b>Cleaning</b> .....	<b>10</b>
<b>Error Messages &amp; FAQ</b> .....	<b>11</b>
<b>Accessories for Purchase</b> .....	<b>11</b>
<b>Replacement Parts</b> .....	<b>11</b>
<b>Warranty</b> .....	<b>12</b>

# IMPORTANT SAFEGUARDS

HOUSEHOLD USE ONLY • READ ALL INSTRUCTIONS BEFORE USE

When using electrical appliances, basic safety precautions should always be followed, including the following:

## ⚠ WARNING

- 1 Read all instructions prior to use.
- 2 Remove and discard all packaging materials and labeling before use.
- 3 This appliance can be used by persons with reduced physical, sensory or mental capabilities or lack of experience and knowledge if they have been given supervision or instruction concerning use of the appliance in a safe way and understand the hazards involved.
- 4 Take inventory of all contents to ensure you have all parts needed to properly and safely operate.
- 5 **DO NOT** run the unit without the crumb tray fully installed.
- 6 **DO NOT** run the unit in the Oven position without the bake tray fully inserted. **DO NOT** override the bake tray detect switch.
- 7 Keep the appliance and its cord out of reach of children. Do not allow the appliance to be used by children. Close supervision is necessary when used near children.
- 8 **DONOT** use an extension cord. A short power-supply cord is used to reduce the risk of children grabbing the cord or becoming entangled and to reduce the risk of people tripping over a longer cord.
- 9 **DONOT** let cord hang over edges of tables or counters or touch hot surfaces, including stoves and other heating ovens.
- 10 **DO NOT** place on hot stovetop or in hot oven. NEVER use outlet below counter.
- 11 **NEVER** leave the unit unattended while in use.
- 12 **DONOT** cover crumb tray or any part of the unit with aluminum foil. This may cause the unit to overheat or cause a fire.
- 13 To protect against electrical shock **DO NOT** immerse cord, plugs, or main unit housing in water or other liquid.
- 14 **DO NOT** use the unit with damage to the power cord or plug. Regularly inspect the unit and power cord. If the unit malfunctions or has been damaged in any way, immediately stop use and call Customer Service.
- 15 Prevent food contact with heating elements. Excessive or oversized food loads, metal foil packages, or utensils must NOT be inserted as they may cause risk of fire or electric shock.
- 16 Extreme caution must be used when the unit contains hot food. Improper use may result in personal injury.
- 17 **ALWAYS** use the lightest toast setting when heating toaster pastries.
- 18 **DONOT** cover the air intake vents or air outlet vents while unit is operating. Doing so will prevent even cooking and may damage the unit or cause it to overheat.
- 19 **DONOT** insert anything in the ventilation slots and do not obstruct them.
- 20 **DO NOT** use accessory and attachments not recommended or sold by SharkNinja.
- 21 **DO NOT** place items on top of surface, including food, while unit is operating except for authorized recommended Ninja accessories.
- 22 Before placing any accessories into the unit ensure they are clean and dry.
- 23 Intended for countertop use only. **DO NOT** place the unit near the edge of a countertop. Ensure the surface is level, clean and dry.
- 24 This unit is for household use only. **DO NOT** use this unit for anything other than its intended use. Misuse may cause injury.
- 25 **DO NOT** use outdoors. **DO NOT** use in moving vehicles or boats.
- 26 **DONOT** operate in enclosed space or under cabinets.
- 27 Provide adequate space above (minimum 10"/254mm) and on all sides (minimum 4"/102mm) for air circulation.

- 28 **DO NOT** place anything on the unit during operation. A fire may occur if the unit is covered or touching flammable material, including curtains, draperies, walls, or the like when in operation.
- 29 **DO NOT** spray any type of aerosol spray or flavoring inside the unit while cooking.
- 30 Use caution when inserting and removing anything from the unit, especially when hot.
- 31 Outlet voltages can vary, affecting the performance of your product. To prevent possible illness, use a thermometer to check that your food is cooked to the temperatures recommended.
- 32 **DO NOT** insert metal utensils such as a knife into the unit to remove jammed toast, bagels or any other items. This can damage the heating elements or cause electric shock.
- 33 Unplug the unit and allow it to cool before cleaning any food that become stuck or spilled into cavity.
- 34 **DO NOT** place any of the following materials in the unit: paper, cardboard, plastic, roasting bags and the like. They may cause fire.
- 35 Extreme caution should be exercised when using containers constructed of any materials other than metal or glass.
- 36 **DO NOT** touch hot surfaces. Unit surfaces are hot during and after operation. To prevent burns or personal injury, **ALWAYS** use protective hot pads or insulated oven mitts and use available handles and knobs.
- 37 Please refer to the Cleaning & Maintenance section for regular maintenance of the unit.
- 38 Cleaning and user maintenance shall not be made by children.
- 39 Press the power button to turn unit off and allow to cool completely before cleaning, moving and flipping for storage.
- 40 Unplug from outlet when not in use. To unplug, grasp the plug by the body and pull from the outlet. Never unplug by grasping and pulling the flexible cord.
- 41 **DO NOT** clean with metal scouring pads. Pieces can break off the pad and touch electrical parts, causing a risk of electrical shock.
- 42 **DO NOT** store any materials, other than supplied accessories, in the unit when not in use.
- 43 **DO NOT** use the unit as a source of heat or for drying.
- 44 **DO NOT** use bake tray without handle installed.



Indicates to read and review instructions to understand operation and use of product.



Indicates the presence of a hazard that can cause personal injury, death or substantial property damage if the warning included with this symbol is ignored.



Take care to avoid contact with hot surface. Always use hand protection to avoid burns.



For indoor and household use only.

## SAVE THESE INSTRUCTIONS

## PARTS

### A Main Unit

(Attached power cord not shown)

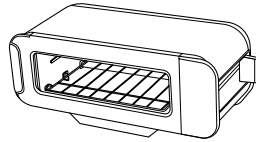

**NOTE:** Crumb tray in back of unit is not fully removable.

### B Bake Tray

(Place in unit for Oven position functions)  
Hand-wash only

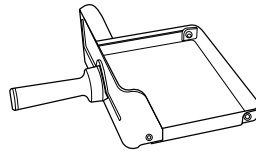

**ASSEMBLY INSTRUCTIONS:** Permanently attach handle to the bake tray by screwing in clockwise until fully attached.

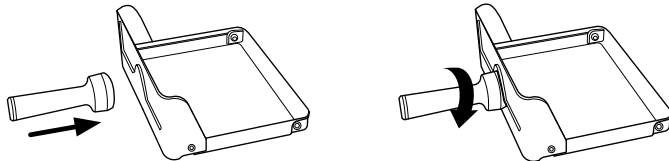

## MOVING BETWEEN COOKING POSITIONS

- 1 Flip unit down to the Oven position.
- 2 Push toast lever back to open the cooking cavity. There will be audible click. "LOC" will appear on the display if toast lever is not in the lock position.
- 3 Insert bake tray. Select function and set cook time and temp.
- 4 Press START/STOP to begin cooking.

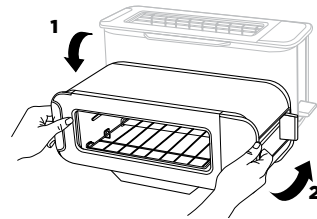

**NOTE:** Sneak a peek at your food during cooking by removing the bake tray. The unit will pause until the bake tray has been reinserted.

## BEFORE FIRST USE

- 1 Remove and discard any packaging material, stickers, and tape from the unit.
- 2 Remove all accessories from the package and read this manual carefully. Please pay particular attention to operational instructions, warnings, and important safeguards to avoid any injury or property damage.
- 3 Wash the bake tray in warm, soapy water, then rinse and dry thoroughly. **NEVER** submerge the main unit in water.
- 4 We recommend flipping the unit to the Oven position, placing the bake tray inside the unit, and running it on Bake at 400°F for 10 minutes without adding food. See page 8 for instructions on moving to the Oven position for Bake. Make sure the area is well ventilated, as some odor may be released. This removes any packaging residue and odor traces that may be present. This is completely safe and not detrimental to the performance of the toaster.

**NOTE:** For longest accessory life, we recommend hand-washing the accessories.

## POWER CORD MANAGEMENT

Our cord-management system is designed so it will not interfere with the toaster's flip functionality.

### Option 1: Outlet on the right

Place the cord in the left hook on the back of the Flip Toaster. Twist the cord so the wide side is horizontal in order to securely fasten the cord in the hook.

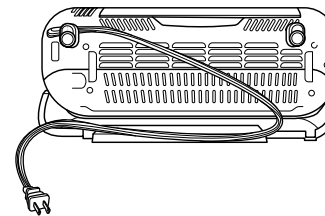

### Option 2: Outlet on the left or behind toaster

Place the cord in both hooks on the back of the Flip Toaster. Twist the cord so the wide side is horizontal in order to securely fasten the cord in the hooks.

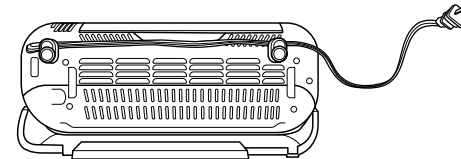

# USING THE CONTROL PANEL

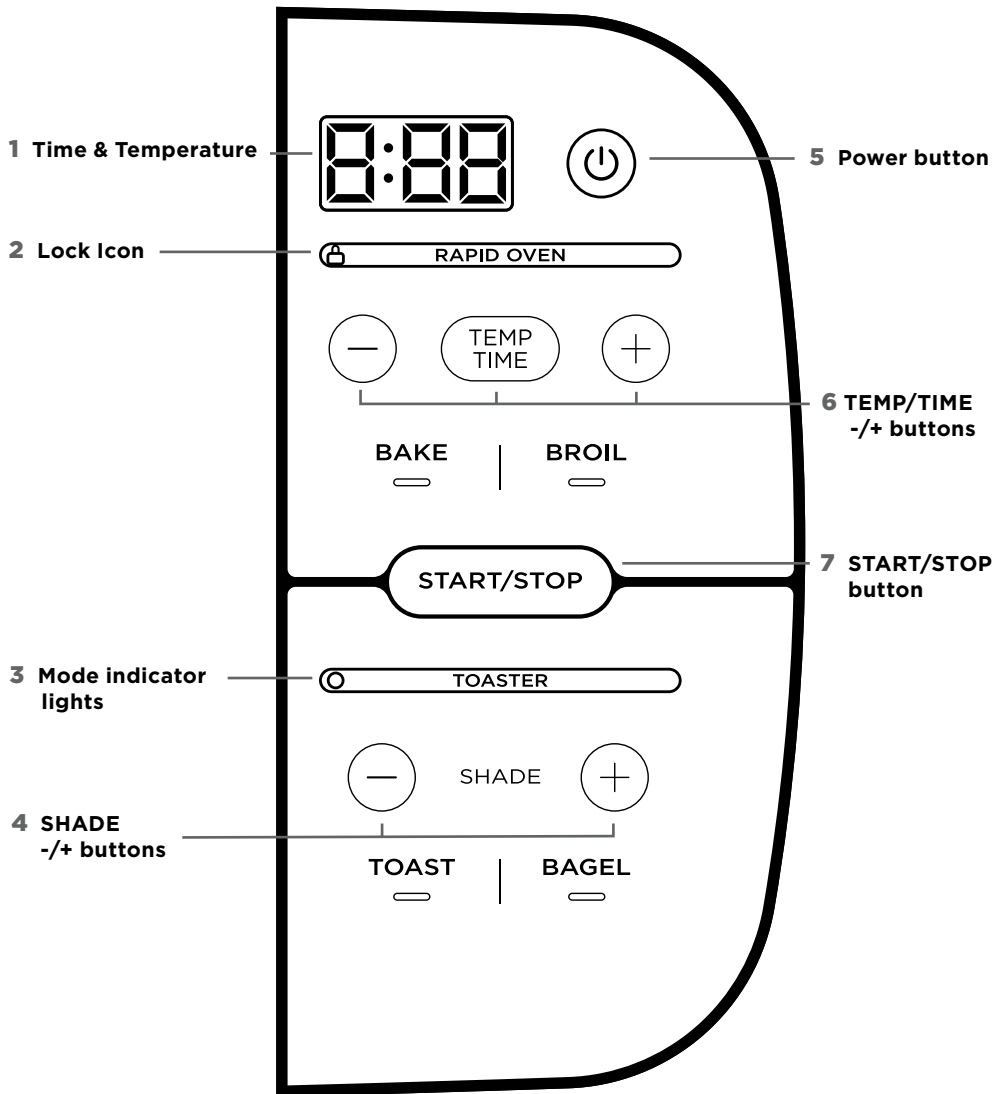

## FUNCTIONS

**BAKE:** Evenly bakes everything from your favorite personal pizzas to biscuits.

**BROIL:** Broils and evenly browns the tops of foods like cheesy toast.

**REHEAT:** Quickly reheat cooked foods like a slice of pizza.

**TOAST:** Evenly toasts up to 2 slices of bread to your perfect level of darkness.

**BAGEL:** Perfectly toast up to 2 bagel halves when they're placed cut-side forward in the toaster. The icon on the unit will show instructed direction.

**DEFROST:** Toggle on for added time when using Toast or Bagel functions with frozen bread.

**NOTE:** The Defrost and Reheat functions are not included on all models.

## CONTROL PANEL DISPLAY & OPERATING BUTTONS

**1 Time & Temperature display:** Shows the cook time and will count down when cooking is in progress. Press TEMP/TIME button to toggle to temperature display.

**2 Lock icon:** Signifies in Oven orientation if the toast lever is pushed all the way back in lock position. Will illuminate if locked and flash if not locked.

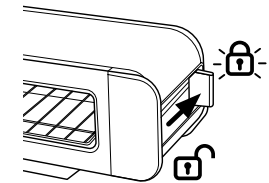

**3 Mode Indicator lights:** Signify Oven or Toaster orientation. Flip unit down and slide lever back until it clicks into place to lock toaster in oven position.

**NOTE:** "LOC" will appear on the display if toast lever is not in the lock position.

**NOTE:** "NO PAN" will appear on the display if the bake tray is not inserted when cooking begins. Sneak a peek at your food during cooking by removing the bake tray. The unit will pause until the bake tray has been reinserted.

**4 SHADE +/- buttons:** Adjust the toast shade for Toast and Bagel functions.

**5 Power button:** Press to turn unit on or off.

**6 TEMP/TIME +/- buttons:** Press TEMP/TIME to toggle between selections, then use +/- buttons to adjust.

**NOTE:** Cook time and temperature will revert to the same settings from the last time the unit was in use.

**7 START/STOP button:** Press to start or stop cooking or toasting. Cooking will begin shortly thereafter.

**NOTE:** The cook time and temperature may be adjusted at any time during cooking.

# USING YOUR FOODI™ FLIP TOASTER

## USING THE COOKING FUNCTIONS

To turn on the unit, plug the power cord into a wall outlet, and press the  button.

### Flipping to the Oven Position

From the Toaster position, flip the unit down and push the toast lever back to lock position or until you hear an audible click.

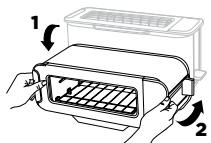

**NOTE:** To unlock lever, simply flip the unit back up to Toaster Position.

### Bake

- 1 Flip unit down to the horizontal position and push the lever back to lock position. Select BAKE. The last temperature set will appear on the display.
- 2 Use the +/- buttons to select a temperature between 250°F and 400°F. Press the TEMP/TIME button to lock in the temperature.
- 3 Press the TEMP/TIME button again to see the time display. Then use the +/- buttons to select a time between 1 minute and 45 minutes.
- 4 Place ingredients on the bake tray and insert in unit Press START/STOP. Cooking will begin when the tray is correctly inserted. Cook will not start if the tray is not fully inserted.
- 5 During cooking, you can remove the bake tray to check on food. The timer will pause until the bake tray has been reinserted in the unit.
- 6 When cook time reaches zero, the unit will beep.

### Broil

- 1 Flip unit down to the horizontal position and push the lever back to lock position. Select BROIL.
- 2 Press the TEMP/TIME button to see the time display. Then use the +/- buttons to select a time between 1 minute and 10 minutes.

**NOTE:** Broil operates on high (400°F). The temperature cannot be adjusted.

- 3 Place ingredients on the bake tray and insert tray in unit Press START/STOP. Cooking will begin when the tray is correctly inserted.
- 4 During cooking, you can remove the bake tray to check on food. The timer will pause until the bake tray has been reinserted in the unit.
- 5 When cook time reaches zero, the unit will beep.

### Reheat

- 1 Flip unit down to the horizontal position and push lever back to lock position. Select REHEAT. The last temperature set will appear on the display.
- 2 Use the +/- buttons to select a temperature between 250°F and 350°F. Press the TEMP/TIME button to lock in the temperature.
- 3 Press the TEMP/TIME button again to see the time display. Then use the +/- buttons to select a time between 1 minute and 45 minutes.
- 4 Place ingredients on the bake tray and insert tray in unit Press START/STOP. Cooking will begin when the tray is correctly inserted.
- 5 During cooking, you can remove the bake tray to check on food. The timer will pause until the bake tray has been reinserted in the unit.
- 6 When cook time reaches zero, the unit will beep.

**NOTE:** If cooking for less than 10 minutes, the clock will count down by minutes and seconds. If cooking for 10 minutes or more, the clock will count down by minutes only until the time reaches below 10 minutes.

**NOTE:** Reheat function not available on all units.

### Flipping to the Toaster Position

From the Oven position, flip the unit up. The toast lever will spring up to reset for toasting.

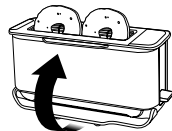

## TIPS FOR CHOOSING YOUR SHADE SELECTION

- With multiple slices, place next to each other. Make sure there is no overlap of the slices so they can toast consistently. If bread slices do not fit next to each other, try rotating them sideways for a better fit.
- For drier or stale breads, adjust the shade lower than your standard setting.
- For freshly baked or whole wheat breads, adjust the shade higher than your standard setting.
- For bread with an unsmooth surface (like English muffins), adjust the shade higher than your standard setting. Be sure to slice bread evenly for consistent toasting.
- For thick-cut pieces, adjust the shade higher than your standard setting. Be sure to slice bread evenly for consistent toasting.
- Split bagels in half before toasting. Place the cut side facing you, with the control panel on the right side.
- For frozen waffles, frozen French toast, or frozen bagels, use the appropriate function and toggle on Defrost.
- Do not place buttered bread in the unit. Butter after toasting.
- Be aware that very thin slices may burn. Use the lowest shade selection and monitor while toasting.

SETTING	COLOR
1-2	Light
3-5	Medium
6-7	Dark

## Toast

- 1 Flip unit up to the vertical position. Select the TOAST function.
- 2 Use the +/- SHADE buttons to select the desired shade level.

**NOTE:** There is no temperature adjustment available for the Toast function.

- 3 Place bread slices in the unit. Push the lever down to start toasting.

**NOTE:** Check on progress during toasting by lifting lever to raise toast. Toasting will not pause, so push lever back down promptly after checking.

- 4 When toasting time reaches zero, the unit will beep and the lever and toast will pop up. Cancel a cycle early by pressing the START/STOP button.

**NOTE:** The unit uses an algorithm to ensure consistent shade results whether toasting from a cold or pre-warmed unit. As a result, the total toast time may change — to add more or less time, press the shade buttons.

**NOTE:** Heating elements will cycle on and off during cooking to maintain the set temperature.

## Bagel

- 1 Flip unit up to the vertical position. Select the BAGEL function.
- 2 Use the +/- SHADE buttons to select the desired shade level.
- 3 Place bagel halves, cut-side facing you, in the unit. Push the lever down to start toasting.

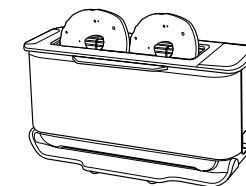

- 4 When toasting time reaches zero, the unit will beep and the lever and bagel halves will pop up. Cancel a cycle early by pressing the START/STOP button.

## USING YOUR FOODI™ FLIP TOASTER - CONT.

**NOTE:** Heating elements will cycle on and off during toasting to maintain the set temperature.

**NOTE:** Check on progress during toasting by lifting lever to raise bagel slices. Toasting will not pause, so push lever back down promptly after checking.

**NOTE:** The unit uses an algorithm to ensure consistent shade results whether toasting with a cold or pre-warmed unit. As a result, the total toast time per shade level may vary. To add more or less time, press the shade buttons.

### Defrost

- 1 Defrost can be used with either the Toast or Bagel function.
- 2 Toggle Defrost on to add extra time for defrosting bread before toasting.

## CLEANING

### CLEANING

The unit should be cleaned thoroughly after every use.

- 1 Unplug the unit and allow it to cool down completely before cleaning.
- 2 Empty crumb tray by partly sliding it out of the unit when the unit is in the vertical position. Wipe crumbs off and fully insert back in unit.

**NOTE:** Empty crumb tray frequently. Always ensure the crumb tray is fully inserted before cooking. Crumb tray is not removable from the unit.

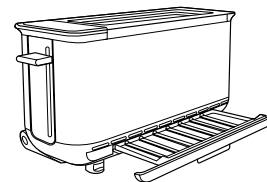

- 3 Use a damp cloth to clean the exterior of the main unit and the control panel. A non-abrasive liquid cleanser or mild spray solution may be used to clean the unit exterior. Apply the cleanser to the cloth, not the unit surface, before cleaning.

**NOTE:** Avoid cooking greasy, fatty foods that create grease splatter, as grease buildup will be harder to clean over time.

## ERROR MESSAGES & FAQ

### ERROR MESSAGES

#### Call Customer Service for the following error messages:

“Er1,” “Er2,” “Er3,” “Er4,” “Er5,” “Er6,” or “Er7”

Turn off and unplug the unit and call Customer Service at **1-877-646-5288**. So we may better assist you, please register your product online at [registeryourninja.com](http://registeryourninja.com) and have the product on hand when you call.

#### Why won't the unit turn on?

- Make sure the power cord is securely plugged into the outlet.
- Try plugging the cord into a different outlet.
- Reset the circuit breaker if necessary.
- Press the Power button.
- If the issue persists after following the steps above, contact customer service.

#### Why aren't the Oven functions illuminated when the unit is in the horizontal position?

- Make sure the toast lever is pushed all the way back to the lock position. You will hear a click when the lever is fully pushed back.
- Make sure the flip foot is on the bottom of the unit.

#### Why does “LOC” appear on the display?

- Before inserting the bake tray when toaster is in the Oven position, you must push the toast lever all the way back to the lock position until you hear an audible click. Once you've successfully locked the toast lever, the “LOC” text will appear on the display and you will be able to insert the bake tray and select a function, time, and temperature.

#### Why does “NO PAN” appear on the display?

- When toaster is in the Oven position, you must insert the included bake tray to start cooking. Other accessories not specified by Ninja(R) are incompatible with this toaster.
- Ensure bake tray is inserted fully into the unit in the Oven position. The front of the bake tray should be flushed to the front walls that surround the cavity.

#### Can I look at my food while the unit is cooking?

- Yes, when the unit is in the horizontal position, you can remove the bake tray at any time to check on your food. The cook time will pause until you reinsert the tray. Auto-shutoff will occur after the bake tray has been removed for 10 minutes.
- When the unit is in the vertical position, you can lift the toast lever at any point to check on progress without canceling toasting.

#### Can I restore the unit to its default settings?

- The unit will remember the last setting used for each function, even if you unplug it. To restore the unit's default settings for each function, press the two SHADE buttons simultaneously for 5 seconds.

#### Why do the heating elements appear to be turning on and off?

- This is normal. The unit is designed to control temperature precisely for every function by adjusting the heating elements' power levels.

## ACCESSORIES FOR PURCHASE

We offer a suite of custom-made accessories for your Ninja® Foodi™ Flip Toaster. Visit [ninjaaccessories.com](http://ninjaaccessories.com) to expand your capabilities and take your cooking to the next level.

## REPLACEMENT PARTS

To order additional parts and accessories, visit [ninjaaccessories.com](http://ninjaaccessories.com) or contact Customer Service at **1-877-646-5288**. So we may better assist you, please register your product online at [registeryourninja.com](http://registeryourninja.com) and have the product on hand when you call.

# Shark | NINJA

## ONE (1) YEAR LIMITED WARRANTY

The One (1) Year Limited Warranty applies to purchases made from authorized retailers of **SharkNinja Operating LLC**. Warranty coverage applies to the original owner and to the original product only and is not transferable.

SharkNinja warrants that the unit shall be free from defects in material and workmanship for a period of one (1) year from the date of purchase when it is used under normal household conditions and maintained according to the requirements outlined in the Owner's Guide, subject to the following conditions and exclusions:

#### What is covered by this warranty?

1. The original unit and/or non-wearable parts deemed defective, in SharkNinja's sole discretion, will be repaired or replaced up to one (1) year from the original purchase date.
2. In the event a replacement unit is issued, the warranty coverage ends six (6) months following the receipt date of the replacement unit or the remainder of the existing warranty, whichever is later. SharkNinja reserves the right to replace the unit with one of equal or greater value.

#### What is not covered by this warranty?

1. Normal wear and tear of wearable parts (such as removable pots, racks, pans, etc.), which require regular maintenance and/or replacement to ensure the proper functioning of your unit, are not covered by this warranty. Replacement parts are available for purchase at [ninjaaccessories.com](http://ninjaaccessories.com).
2. Any unit that has been tampered with or used for commercial purposes
3. Damage caused by misuse, abuse, negligent handling, failure to perform required maintenance (e.g., failure to keep the unit clear of food spills and other debris), or damage due to mishandling in transit.
4. Consequential and incidental damages.
5. Defects caused by repair persons not authorized by SharkNinja. These defects include damages caused in the process of shipping, altering, or repairing the SharkNinja product (or any of its parts) when the repair is performed by a repair person not authorized by SharkNinja.
6. Products purchased, used, or operated outside North America.

#### How to get service

If your appliance fails to operate properly while in use under normal household conditions within the warranty period, visit [ninjakitchen.com/support](http://ninjakitchen.com/support) for product care and maintenance self-help. Our Customer Service Specialists are also available at **1-877-646-5288** to assist with product support and warranty service options, including the possibility of upgrading to our VIP warranty service options for select product categories. So we may better assist you, please register your product online at [registeryourninja.com](http://registeryourninja.com) and have the product on hand when you call.

SharkNinja will cover the cost for the customer to send in the unit to us for repair or replacement. A fee of \$20.95 (subject to change) will be charged when SharkNinja ships the repaired or replacement unit.

#### How to initiate a warranty claim

You must call **1-877-646-5288** to initiate a warranty claim. You will need the receipt as proof of purchase. We also ask that you register your product online at [registeryourninja.com](http://registeryourninja.com) and have the product on hand when you call, so we may better assist you. A Customer Service Specialist will provide you with return and packing instruction information.

#### How state law applies

This warranty gives you specific legal rights, and you also may have other rights that vary from state to state. Some states do not permit the exclusion or limitation of incidental or consequential damages, so the above may not apply to you.



**SharkNinja Operating LLC**  
**US: Needham, MA 02494**  
**1-877-646-5288**  
**ninjakitchen.com**

Illustrations may differ from actual product. We are constantly striving to improve our products, therefore the specifications contained herein are subject to change without notice.

NINJA is a registered trademark of SharkNinja Operating LLC.

FOODI is a trademark of SharkNinja Operating LLC.

This product may be covered by one or more U.S. patents. See [sharkninja.com/patents](http://sharkninja.com/patents) for more information.

© 2021 SharkNinja Operating LLC

PRINTED IN CHINA

ST100Series\_IB\_MP\_Mv14



**@ninjakitchen**